

Technical Bulletin

Selecting Mortar Joints

Mortar joints not only affect the appearance, but can have a significant effect on the weathering performance and durability of a masonry wall. Proper tooling and selection of the type of mortar joint used is extremely important. Mortar joints should also be completely filled with mortar. Special attention should also be given to ensuring head joints are also completely filled with mortar.

General Shale recommends four types of mortar joints which are listed in order of preference below.

Recommended Mortar Joints

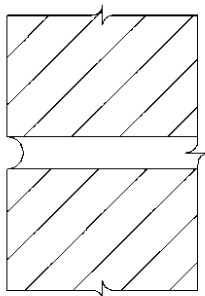

1. CONCAVE

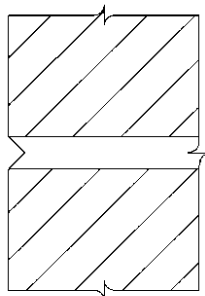

2. V

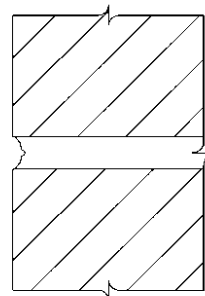

3. GRAPEVINE

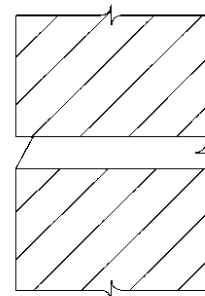

4. WEATHERED

The use of any of the not recommended mortar joints listed below can lead to water penetration problems and may also degrade the durability of the wall due to problems such as freeze thaw spalling damage.

Not Recommended Mortar Joints

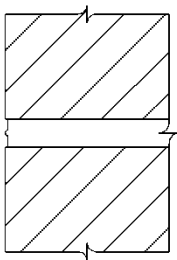

BEADED

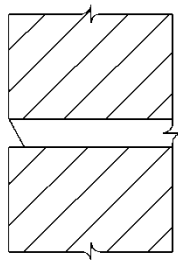

STRUCK

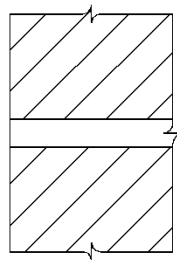

FLUSH

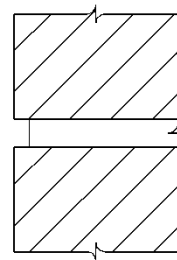

RACKED

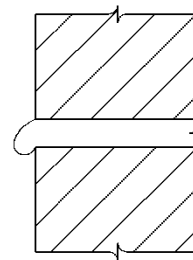

EXTRUDED