



in this photo
THIN BRICK NAME : Trainstation

OLD BRICK ORIGINALS™ THIN BRICK

INSTALLS EVERYWHERE. CHANGES EVERYTHING.



General Shale
THIN MASONRY PRODUCTS

SEE WHAT WE'RE UP TO!



General Shale
THIN MASONRY PRODUCTS

1-800-414-4661
generalshale.com



Copyright © 2017 General Shale, Inc. The photos in this brochure are intended to represent general color range and texture. Precise color fidelity is difficult to obtain in print. Color selection should be made from product samples.

TB-BRO 0002-0517



in this photo
THIN BRICK NAME : Ironworks

MAXIMUM VERSATILITY

With thin brick, your design options are endless. Thin brick can be installed in virtually any interior or exterior space, making it one of the most versatile masonry building products.

in this photo
THIN BRICK NAME : Smokestack



in this photo
THIN BRICK NAME : Towerbridge

OLD BRICK ORIGINALS™ THIN BRICK

Standard Colors



Carriagehouse



Cigarfactory



Cityhall



Englishpub



Frenchquarter



Ironworks



Peppermill



Schoolhouse



Smokestack



Towerbridge



Townsquare



Trainstation



Thin Brick Corner & Flat ▶

Product availability may vary by geographic location. Please visit your local General Shale retail location or contact your local General Shale representative for product availability. Please visit www.GeneralShale.com to find the location nearest you.



PREFERRED INSTALLATION METHODS

The General Shale preferred method of exterior installation is a drainage system with polymer modified mortar.

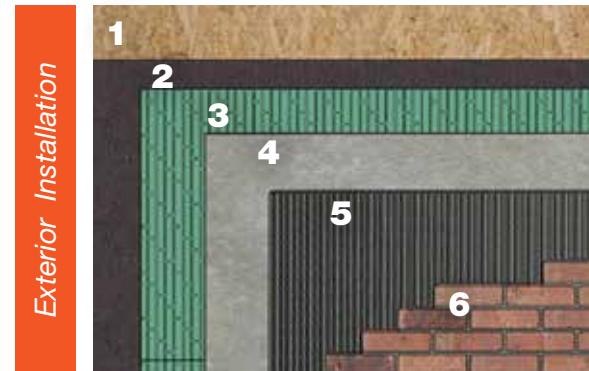

Exterior Installation

1. Sheathing
2. Weather Barrier
3. Drainage Medium
4. Cement Board
5. Thinset
6. Thin Brick & Pointing Mortar

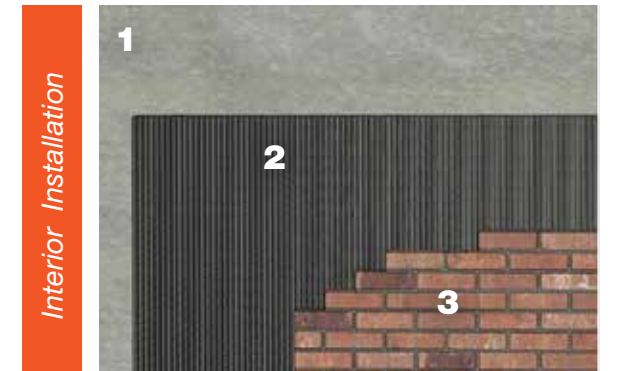

Interior Installation

1. Drywall or Cement Board
2. Thin-set Mortar or Adhesive*
3. Thin Brick & Pointing Mortar

*Non-sagging adhesive recommended. Visit our website for more thin brick installation details.