

ROCK SOLID ORIGINALS™

THIN ROCK

THIN ROCK GIVES YOU THE AUTHENTIC LOOK OF ROCK FOR LESS.

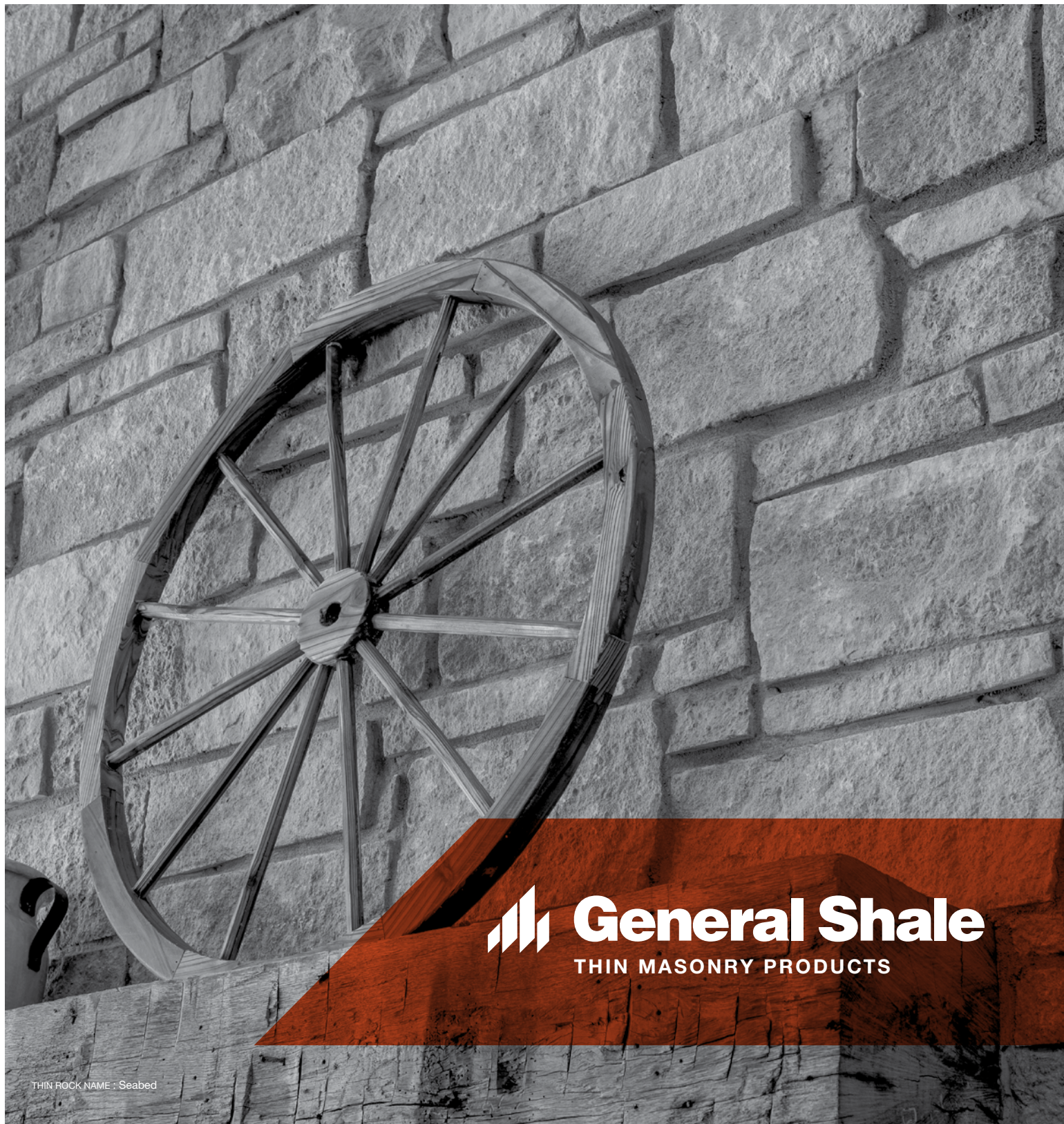

General Shale

THIN MASONRY PRODUCTS

THIN ROCK NAME : Seabed



PREFERRED INSTALLATION METHODS

The General Shale preferred method of exterior installation is a drainage system with polymer modified mortar.

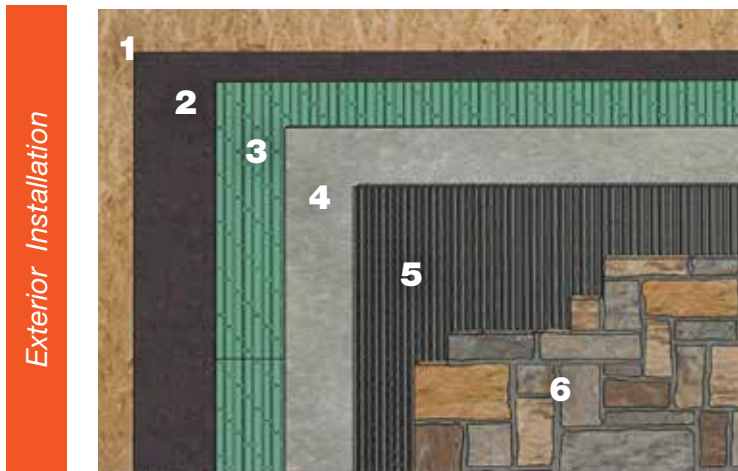

Exterior Installation

1. Sheathing
2. Weather Barrier
3. Drainage Medium
4. Cement Board
5. Thinset
6. Thin Rock & Pointing Mortar



Interior Installation

1. Drywall or Cement Board
2. Thin-set Mortar or Adhesive*
3. Thin Rock & Pointing Mortar

**Non-sagging adhesive recommended. Visit our website for more thin rock installation details.*

ROCK SOLID ORIGINALS™ THIN ROCK

Denver, CO Colors



Adirondack



Alpirsbach



Cherokee



Cimarron



Greycastle



Kiamichi



Sequoyah



Trailhead

Spring City, TN Colors



Honeysuckle



Meadow Creek



Walden Ridge

Product availability may vary by geographic location. Please visit your local General Shale retail location or contact your local General Shale representative for product availability. Please visit www.GeneralShale.com to find the location nearest you.



Aspenbark



Cavanal



Coppercliff



Goldrush



Seabed



Seneca



Tuscany



Wintersky



Rock Creek



Tennessee Fieldstone



Thin Rock Corner & Flat ▶



in this photo
THIN ROCK NAME : Greycastle

THIN ROCK IDEAS

Rock Solid Originals™ offers the high-end rustic look of natural stone for the inside and outside of your home. For more ideas, follow us on Pinterest!

pinterest.com/generalshale



in this photo
THIN ROCK NAME : Tennessee Fieldstone



in this photo
THIN ROCK NAME : Kiamichi



SEE WHAT WE'RE UP TO!



General Shale
THIN MASONRY PRODUCTS

1-800-414-4661
generalshale.com



General Shale masonry products are an integral part of a systems solution for sustainable construction. From highly efficient and environmentally friendly production to extremely long product life cycles, General Shale products can benefit both the environment and the building's occupants.

Our company has a long history of responsible stewardship of the environment and has received numerous awards for our conservationist accomplishments. We are proud of leading the masonry products industry with innovative processes while providing the world's best building materials for customers across North America.



Copyright © 2017 General Shale, Inc. The photos in this brochure are intended to represent general color range and texture. Precise color fidelity is difficult to obtain in print. Color selection should be made from product samples.